

P35



SUCTION CUP WITH CELLULAR RUBBER PROFILE

- ▶ Suitable for irregular and rough surfaces.
- ▶ Use a ball joint if prone to bending.
- ▶ Available with adjustable support for handling thin material. Also suitable for applications requiring accurate positioning.
- ▶ Can also be equipped with a cone valve.

LIFTING FORCES & TECHNICAL DATA

Lifting force vertical to the surface, N, at vacuum level			Lifting force parallel to the surface, N, at vacuum level			Volume	Min. curve radius	Max. vertical movement	Weight with fitting
20 -kPa	60 -kPa	90 -kPa	20 -kPa	60 -kPa	90 -kPa	cm ³	mm	mm	g
20.0	50	70	—	—	—	6.0	—	3.0	22

MATERIAL SPECIFICATIONS

Material	Colour	Hardness °Shore A	Temperature range °C
Ethylene propylene, EPDM	Grey	—	-40–100

MATERIAL RESISTANCE

Wear resistance	Oil	Weather & Ozone	Hydrolysis	Petrol	Concentrated acids	Alcohol	Oxidation
Fair	Poor	Excellent	Good	Poor	Poor	Excellent	Excellent

ORDERING INFORMATION

Complete suction cups		Art. No.
A	Suction cup P35 Ethylene propylene, 1/8" NPSF female	3350045
B	Suction cup P35 Ethylene propylene, 1/8" NPSF female, with cone valve	3350038
B	Suction cup P35 Ethylene propylene, 1/8" NPSF female, adjustable support with filter	3350035

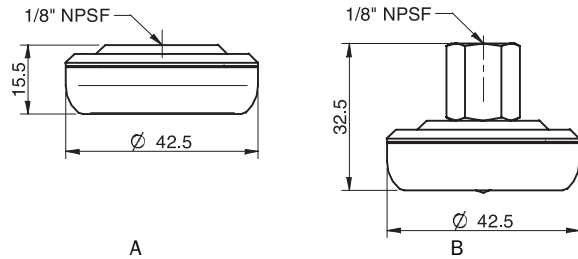

Rubber parts		Art. No.
Suction cup P35 Ethylene propylene		3350023
Fittings & accessories		Art. No.
Fitting 1/8" NPSF female		3350100
Adjustable support for P35, with filter		3350030
Cone valve for P35 & P60		3350033